

POS.	A	B	C	D	E	F	PART-NO.
15	30.80	16.92	25.00	2.29	1.14	7.04	DLH1XP8AK53X
26	39.20	25.25	33.30	2.29	1.14	6.88	DLH2XP8AK53X
44	53.10	38.96	47.10	2.29	1.14	6.88	DLH3XP8AK53X
62	69.40	55.42	63.50	2.41	1.20	7.00	DLH4XP8AK53X

(b)

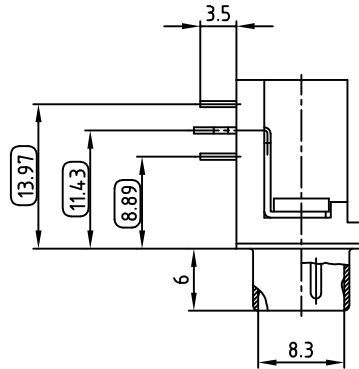

used for: D-SUB HD

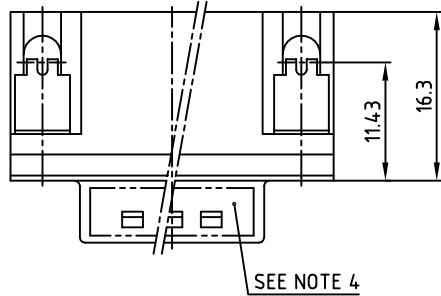
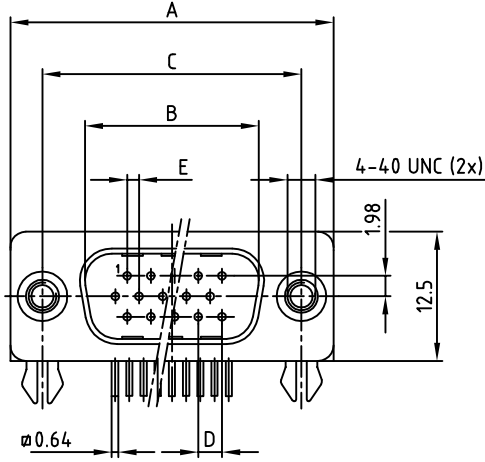
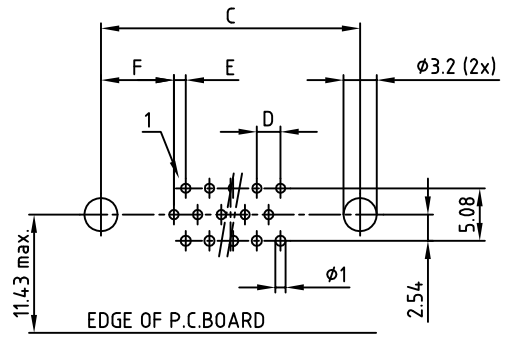

RECOMMENDED P.C.B. LAYOUT (TOP VIEW)
TOLERANCES: ±0.05mm

SPECIFICATION:

- MATERIAL**
 - INSULATOR: THERMAL PLASTIC UL 94 V-0
 - CONTACTS: COPPER ALLOY
 - SHELL: STEEL
 - RIVET, BOARDLOCK: COPPER ALLOY
- CONTACT PLATING**
 - UNDERPLATE: 50µ" NICKEL
 - CONTACT AREA: GOLD FLASH
 - SOLDER TAILS AREA: 100µ" TIN / LEAD FREE
- ELECTRICAL:**
 - OPERATION VOLTAGE: 250 VAC max.
 - CURRENT RATING: 3 AMPS. MAX.
 - CONTACT RESISTANCE: 15 MOHMS MIN @ 500 VDC
 - DIELECTRIC WITHSTANDING VOLTAGE: 1000 VAC / MINUTE
 - OPERATING TEMPERATURE: -55 °C TO +105 °C
- CONNECTOR IS PART MARKED: PART-NO. CONEC ABC
- = CHECK DIMENSION

Directive 2002/95/EC
„RoHS“
Compliant

APPROVAL # FREIGABE # DEBLOCAGE # AUTORIZACION # APPROVAL	
CUSTOMER APPROVAL DATE:	
NAME:	TITLE:
COMPANY NAME:	
APPROVAL # FREIGABE # DEBLOCAGE # AUTORIZACION # APPROVAL	

THIS DRAWING MAY NOT BE COPIED OR REPRODUCED IN ANY WAY, AND MAY NOT BE PASSED ON TO A THIRD PARTY, WITHOUT WRITTEN PERMISSION.
OWNERSHIP AND COPYRIGHT OF CONEC GmbH
DO NOT ALTER CAD DRAWING BY HAND

rev.	description	date	name
1 x b	Ä3146	15.10.2008	Sonne
a	Origin		

tolerance		scale:	2:1
	dim. in mm	material:	SEE SPECIFICATION
2005	date	name	title:
drawn	21.11.	Lehmenkühler	D-SUB HD MALE 90°
appd.	21.11.	Mickenbecker	15-62pos. SOLDER PIN ANGLED 0.350inch with threaded insert and clip
norm			dwg no: AutoCAD 2004 DIN-A
d-old			16K1A1571 3
			sh: 1/1
			part no: SEE TABLE

