

Technical specification/

Technische Daten:

| | |
|--|--|
| Rated voltage/ Bemessungsspannung: | 48 V AC / 60 V DC |
| Current rating/ Strombelastbarkeit: | 7 A at 40 °C 7 A bei 40 °C |
| Degree of protection/ Schutzart: | IP67 in mated condition/ IP67 im gesteckten Zustand |
| Temperature range Connector/ Umgebungstemperatur Stecker: | -40 °C ... +85 °C |
| Temperature range Wire/ Umgebungstemperatur Leitung: | fixed/ -40 °C... +80 °C fest: moved/ -25 °C... +80 °C bewegt: |
| Mating cycles/ Steckzyklen: | >=100 |
| Wire cross section/ Anschlussquerschnitt: | 0.75 mm ² |
| Housing/ Gehäuse: | Deutsch, DT06-4S-P012, black / schwarz |

Materials/

Werkstoffe:

| | |
|--|-----------------------------------|
| Contact/ Kontakt: | Copper alloy/ Kupferlegierung: |
| Contact carrier/ Kontaktträger: | Thermoplastic/ Thermoplastik |
| Contact plating/ Kontaktoberfläche: | Ni |
| Overmolding/ Umspritzung: | TPU, UL 94, black/ schwarz |

Contact assignment/

Kontaktbelegung:

| | |
|------------------|--------------------|
| E1 brown/braun | A1/1 brown/braun |
| E2 white/weiß | A1/2 white/weiß |
| E3 blue/blau | A1/3 blue/blau |
| E4 black/schwarz | A1/4 black/schwarz |
| | A2/1 brown/braun |
| | A2/2 white/weiß |
| | A2/3 blue/blau |
| | A2/4 black/schwarz |

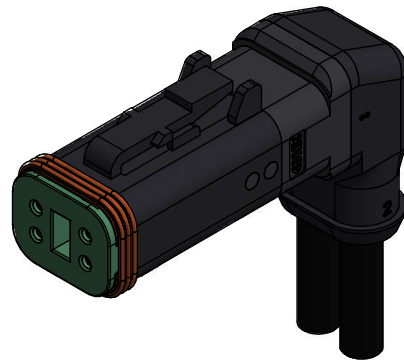

| Part.-no./ Art.-Nr.: | Description/ Beschreibung | Cable Length "L"/ Kabellänge: | Cable/ Kabel: |
|-------------------------|--------------------------------------|----------------------------------|---|
| 55-01602 | YDT06-4SW1-A/K1/0.75/1m-K1/0.75/1m | 1 m | PUR, black/schwarz 4x0.75mm ² , Kabel / cable: 781-K1740G |
| 55-01843 | YDT06-4SW1-A/K1/0.75/2m-K1/0.75/2m | 2 m | |
| 55-01844 | YDT06-4SW1-A/K1/0.75/5m-K1/0.75/5m | 5 m | |
| 55-01845 | YDT06-4SW1-A/K1/0.75/10m-K1/0.75/10m | 10 m | |
| 55-xxxxx | YDT06-4SW1-A/K1/0.75/..m-K1/0.75/..m | ...m | |

tolerance of cable/
Kabeltoleranz:

L <= 4m: L + 40mm
> 4m: L + 1%

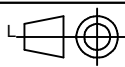

dim. in mm

general tolerance/
Allgemeintoleranz:

0 ± 0,50 mm
0,0 ± 0,25 mm
0,00 ± 0,10 mm
* ± 5°

drawn/
gez.

Date/Datum

Name

appd./
gepr.

21.09.2021

Unkrüer

21.09.2021

Koch

Index: a Original

scale/Maßstab:

1 : 1
(Div.)

CONEC®

dwg no /
Z.-nr.:

55K1A1487

DIN-
A4

RoHS compliant/konform

1 / 1