

NOTES:

1. FOR WAVESOLDERING (SOLDER BATH TEMPERATURE 260°C FOR 5 SEC. AND SOLDER PREHEAT 120°C FOR 120 SEC.)
2. METAL SHELLS: STEEL; min. 315µm TIN over 40-80µm NICKEL
3. INSULATORS: PBT GF UL 94 V-0, BLACK
4. HIGH POWER CONTACTS 20A: COPPER ALLOY
PLATING MATING AREA: 30µm HARD GOLD over min. 50µm NICKEL
PLATING TERMINATION SIDE: 160-240µm TIN over 80µm NICKEL
MALE CONTACT ON POS. A2, FEMALE CONTACT ON POS. A1 and A3
5. METAL BRACKETS: ZINC DIE CAST; 300µm COPPER/40-120µm NICKEL/120-200µm TIN
6. THREADED INSERTS: COPPER ALLOY; min. 200µm TIN over 80µm NICKEL
7. PCB SNAPS: COPPER ALLOY; min. 200µm TIN over 80µm NICKEL
PCB-HOLE: $\phi 3.1 \pm 0.1$ mm; PCB-THICKNESS: 1,6mm
8. P.C.B. HOLE DRILLINGS ON SHEET 2
9. CAPACITANCE: 1.3 nF $\pm 20\%$
10. DIELECTRIC WITHSTANDING VOLTAGE: 707 VDC
11. MAXIMUM TORQUE VALUE FOR THREAD: 6 in.LB
12. CONNECTOR IS PART MARKED: 3F3CSC05S56K40X CONEC ABC

Directive 2002/95/EC RoHS compliant

THIS DRAWING MAY NOT BE COPIED OR REPRODUCED IN ANY WAY, AND MAY NOT BE PASSED ON TO A THIRD PARTY WITHOUT WRITTEN PERMISSION. OWNERSHIP AND COPYRIGHT OF CONEC GmbH DO NOT ALTER CAD DRAWING BY HAND	tolerance		dim. in mm	scale: 2:1 (5:1)		
				material: see notes		
	drawn	31.05.11	name		title: D-SUB FILTER COMBINATION FEMALE 90°, 3F3CS with threaded insert, metal bracket and snap	
	appd.	03.06.11	name			
	norm		name			
d-old		name		dwg no:	DIN-A3	
a	Original			24K1A1326		
rev.	description			date	name	part no:
sh: 1						

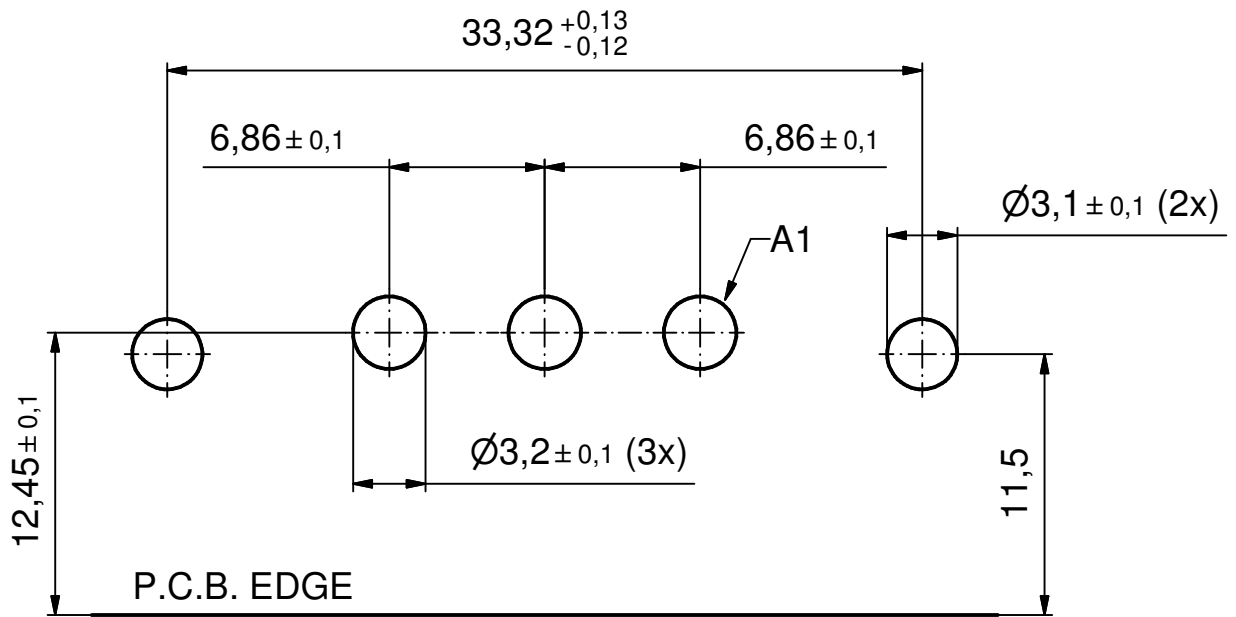

THIS DRAWING MAY NOT BE COPIED OR REPRODUCED IN ANY WAY, AND MAY NOT BE PASSED ON TO A THIRD PARTY WITHOUT WRITTEN PERMISSION.
 OWNERSHIP AND COPYRIGHT OF CONEC GmbH

DO NOT ALTER CAD DRAWING BY HAND

rev.	description	date	name
a	Original		

tolerance		dim. in mm	
drawn	31.05.11	name	Henneboel
appd.	03.06.11	name	Fischer
norm			
d-old			



scale:	3:1
material:	SEE SHEET 1
title: P.C.B. HOLE DRILLINGS D-SUB FILTER COMB. FEMALE 90° 3F3CS with threaded insert, metal bracket and snap	
dwg no:	24K1A1326
part no:	SEE SHEET 1
	DIN-A4 sh: 2