

Part no. / Part marked/ Art.-Nr. / Bedruckung:	Quality class/ Gütestufe:	Contact plating/ Kontakt Veredelung:	Capacitance value/ Kapazitätswert:
24-005733	3	Gold flash over nickel <i>Gold über Nickel</i>	370 pF ± 20 %
24-005732	2	20 µin hard gold over min. 50 µin nickel <i>20 µin Gold über min. 50 µin Nickel</i>	
24-005731	1	30 µin hard gold over min. 50 µin nickel <i>30 µin Gold über min. 50 µin Nickel</i>	
24-005743	3	Gold flash over nickel <i>Gold über Nickel</i>	830 pF ± 20 %
24-005742	2	20 µin hard gold over min. 50 µin nickel <i>20 µin Gold über min. 50 µin Nickel</i>	
24-005741	1	30 µin hard gold over min. 50 µin nickel <i>30 µin Gold über min. 50 µin Nickel</i>	
24-005753	3	Gold flash over nickel <i>Gold über Nickel</i>	1300 pF ± 20 %
24-005752	2	20 µin hard gold over min. 50 µin nickel <i>20 µin Gold über min. 50 µin Nickel</i>	
24-005751	1	30 µin hard gold over min. 50 µin nickel <i>30 µin Gold über min. 50 µin Nickel</i>	

**Technical specification/  
Technische Daten:**

Working voltage/ Betriebsspannung:	100 V DC
Current rating/ Strombelastbarkeit:	5 A
Insulation resistance/ Isolationswiderstand:	≥ 1 GΩ
Dielectric withstanding voltage/ Spannungsfestigkeit (DWV):	424 VDC
Temperature working range/ Umgebungstemperatur:	- 25 °C ... + 105 °C
Capacitance value/ Kapazitätswert:	see table/ siehe Tabelle
Mating cycles (see table)/ Steckzyklen (siehe Tabelle):	Quality class 1 = 500 Gütestufe 1 Quality class 2 = 200 Gütestufe 2 Quality class 3 = 50 Gütestufe 3



**Materials/  
Werkstoffe:**

Contact/ Kontakt:	Cu alloy, Au over Ni Contact tails pretinned/ Kontaktspitzen verzinkt
Insulator/ Isolierkörper:	High temp. PA UL 94 V-0
Shell/ Gehäuse:	Steel, Sn over Ni
Threaded rear spacer clip/ Gewinde-Abstandsbolzen-Clip:	Cu alloy, Sn over Ni
Collar/ Scheibe:	Cu alloy, Sn over Ni

**Installation specification/  
Montagedaten:**

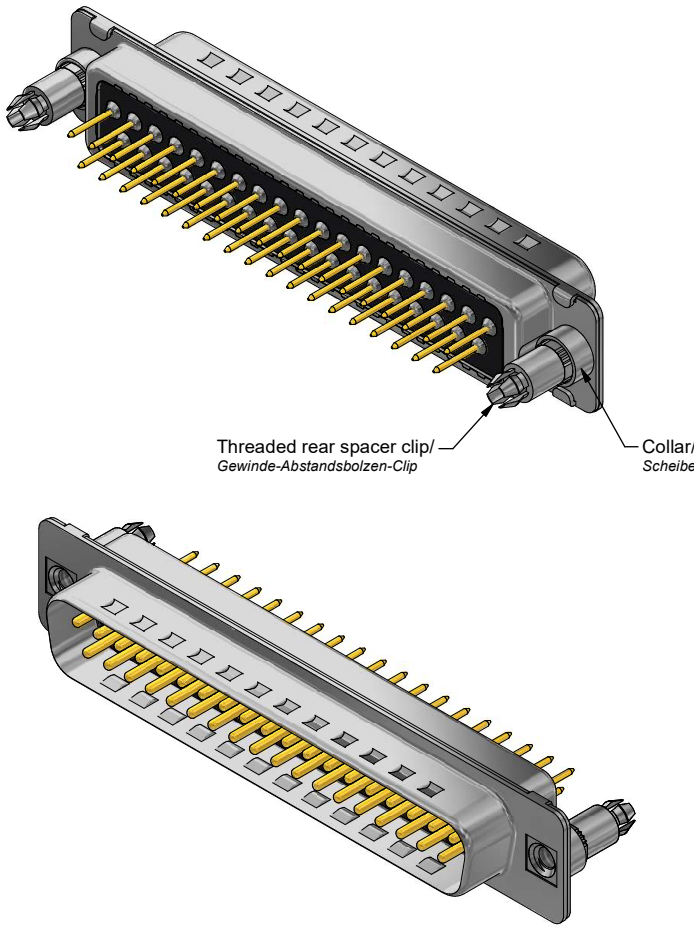
Solder parameter/ Lötparameter:	
Solder preheat temperature/ Vorheiztemperatur:	100 °C for 30 sec./ 100 °C für 30 Sek.
Solder bath temperature/ Lötbadtemperatur:	260 °C for 5 sec./ 260 °C für 5 Sek.
PCB hole drillings/ Leiterplattenbohrbild:	see sheet 2/ siehe Seite 2
Recommended torque value for thread/ Empfohlenes Drehmoment für Gewinde:	max. 6 in.LB/ max. 67 Ncm
PCB snap for hole diameter/ PCB Clip für Lochdurchmesser:	Ø3,1 mm
Circuit board thickness/ Leiterplattenstärke:	1,6 mm



		 dim. in mm		D-SUB C-Filter Male 37pos. with threaded rear spacer clip D-SUB C-Filter Stiftheiste 37pol. mit Gewinde-Abstandsbolzen-Clip	
		Date/Datum	Name		
		drawn/ ges.	15.09.2022 Bub		
				appd./ gepr.	15.09.2022 Schmidt
Index: a Original	Scale/Maßstab: 2:1			dwg no / Z.-nr.:	24K1A2345
RoHS compliant/konform					DIN-A3 1 / 2

The reproduction, distribution and sale of this document as well as the communication of its contents to others without express authorization is prohibited. Offenders will be held liable for the payment of damages. For further information on copyright law please contact the copyright holder. Die Vervielfältigung, Verbreitung, auch auszugsweise, ist ohne schriftliche Genehmigung der CONEC AG.

PCB hole drillings  
(PCB top side)  
Leiterplattenbohrbild  
(Leiterplatten Oberseite)

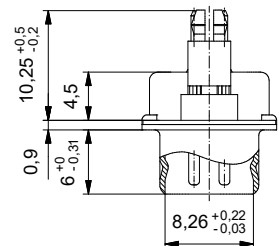
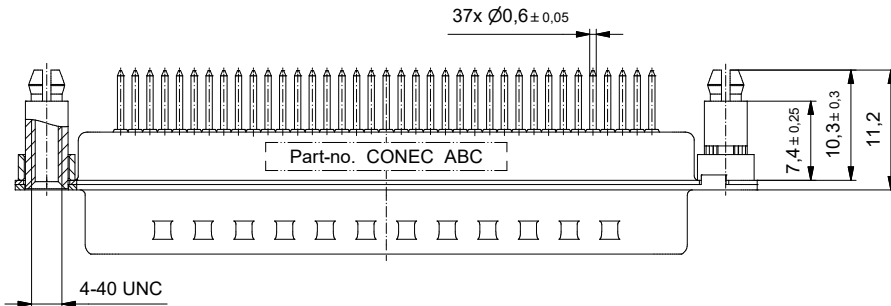
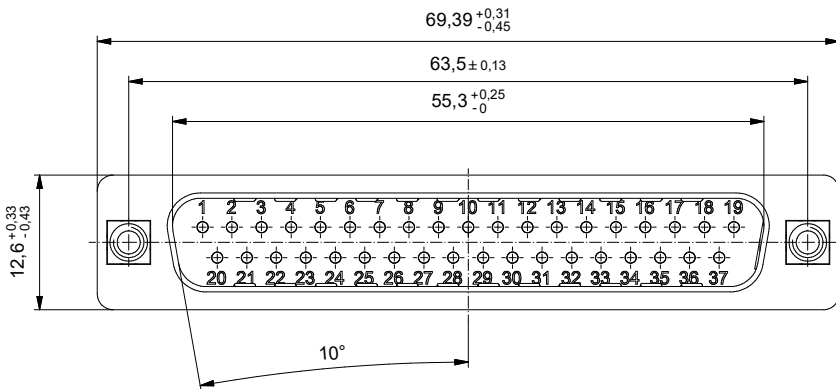
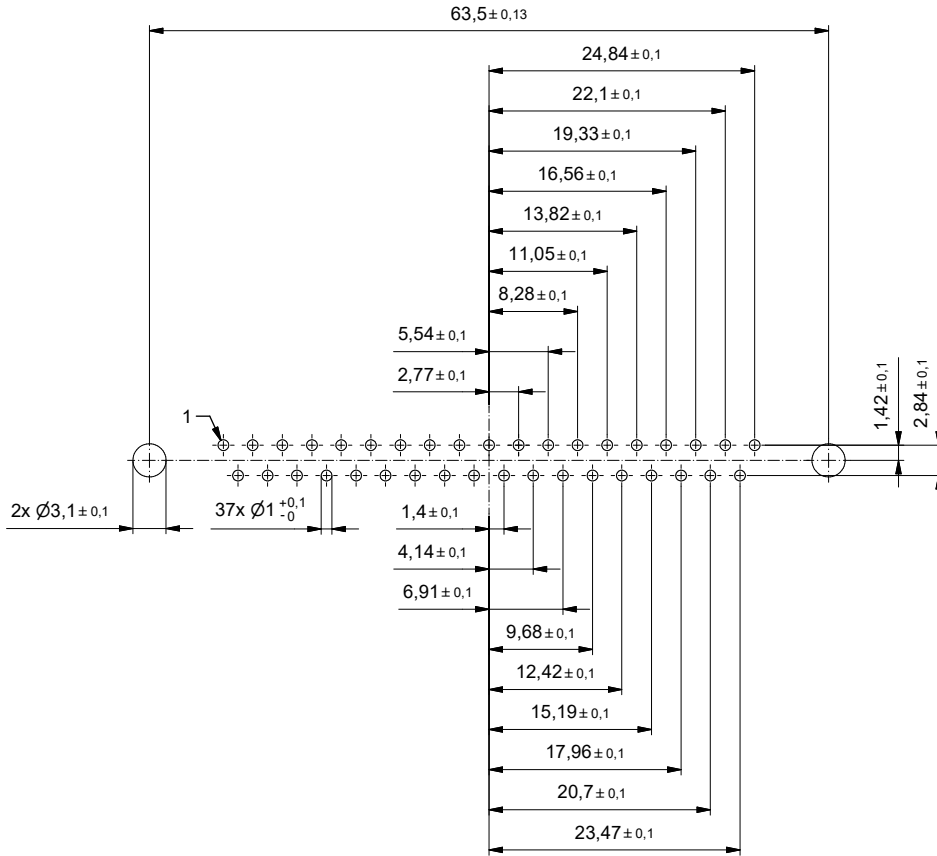

This reproduction, distribution and sale of this document as well as the communication of its contents to others without express authorization is prohibited. Offenders will be held liable for the payment of damages. We reserve the right to withdraw advertising and/or to take legal action.

		dim. in mm		D-SUB C-Filter Male 37pos. with threaded rear spacer clip D-SUB C-Filter Stiftleiste 37pol. mit Gewinde-Abstandsbolzen-Clip	
		Date/Datum	Name		
		drawn/ ges.	15.09.2022 Bub		
		appd./ gepr.	15.09.2022 Schmidt		
Index: a Original	Scale/Maßstab: 2:1			dwg no / Z.-nr.: 24K1A2345	DIN- A3
RoHS compliant/konform					2 / 2