

**NOTES:**

1. METALSHELLS: STEEL; min. 315µin TIN over 40-80µin NICKEL
2. INSULATORS: PBT GF UL 94 V-0; GREEN
3. SIGNAL CONTACTS: COPPER ALLOY  
PLATING: GOLD FLASH over NICKEL
4. NO CONTACTS ON POS. A1 - A4
5. METAL BRACKETS:  
STEEL; min. 320µin TIN over 80µin NICKEL
6. THREADED INSERTS: COPPER ALLOY;  
min. 200µin TIN over 80µin NICKEL
7. PCB-SNAPS: COPPER ALLOY; min. 200µin TIN over 80µin NICKEL  
PCB-HOLE: Ø3,1±0,1mm; PCB-THICKNESS: 1,6mm
8. P.C.B. HOLE DRILLINGS ON SHEET 2
9. MAXIMUM TORQUE VALUE FOR THREAD: 6 in.LB
10. CONNECTOR IS PART MARKED: 3036W4PAT99N40X CONEC ABC

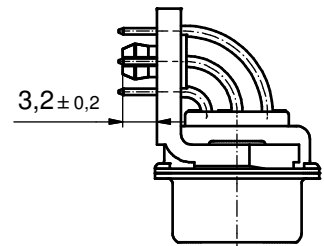
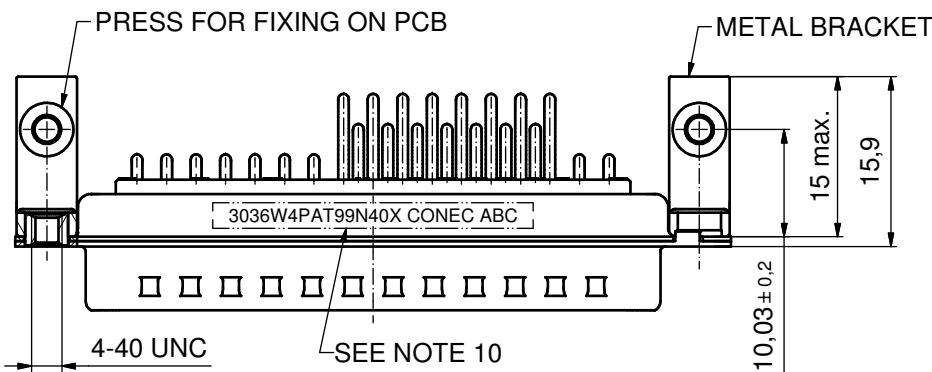
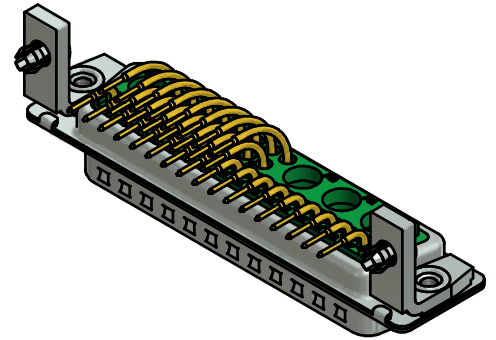
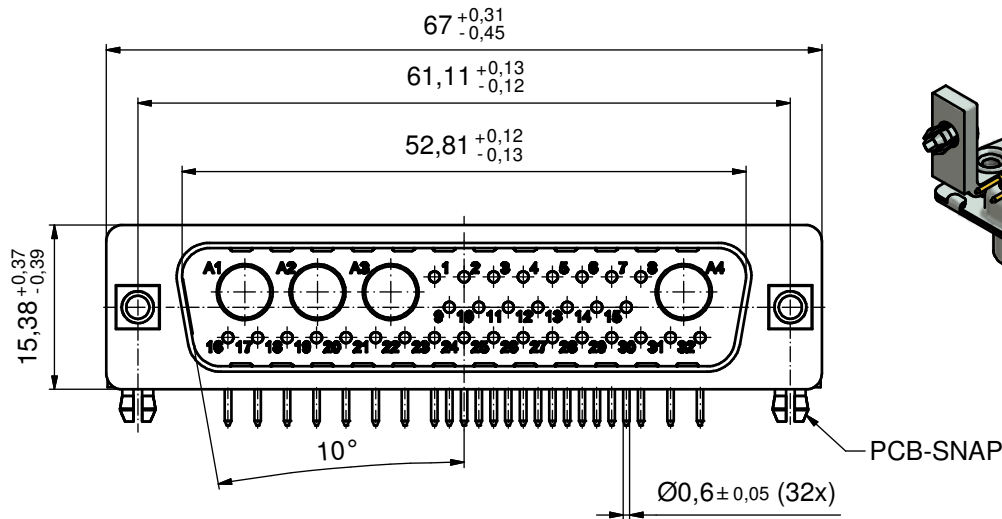
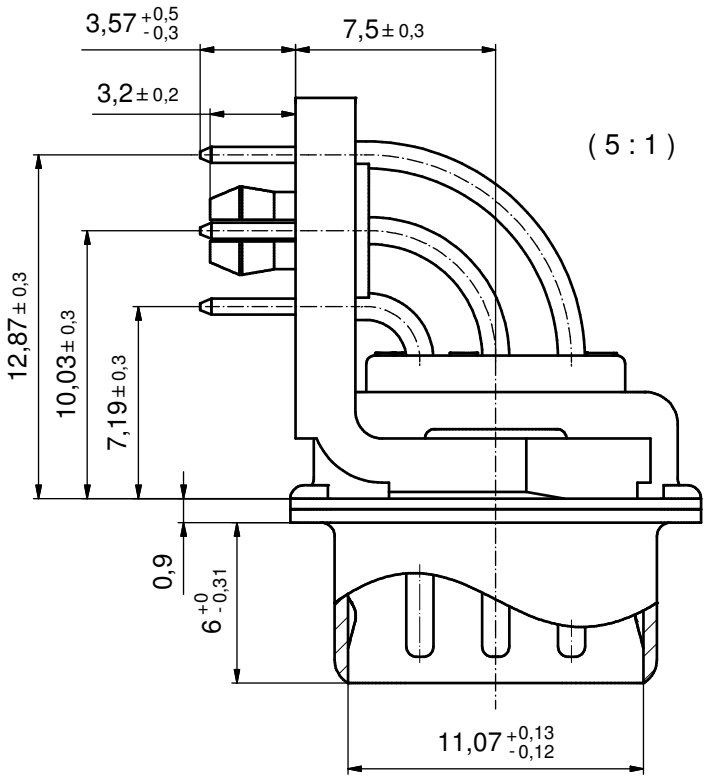

RoHS compliant

THIS DRAWING MAY NOT BE COPIED OR REPRODUCED IN ANY WAY, AND MAY NOT BE PASSED ON TO A THIRD PARTY WITHOUT WRITTEN PERMISSION. OWNERSHIP AND COPYRIGHT OF CONEC GmbH DO NOT ALTER CAD DRAWING BY HAND	tolerance		dim. in mm		scale:	2:1 (5:1)
					material:	see notes
	drawn	30.01.15	Henneboel		title:	
	appd.	30.01.15	Lehmenkühler		D-SUB COMBINATION MALE 90°	
	norm				36W4P	
d-old				with threaded insert, metal bracket and snap		
rev.	a	Original			dwg no:	13K1A4882
description						DIN-A3
date					part no:	3036W4PAT99N40X
name						sh: 1/2



# P.C.B. HOLE DRILLINGS

( P.C.B. TOP SIDE )

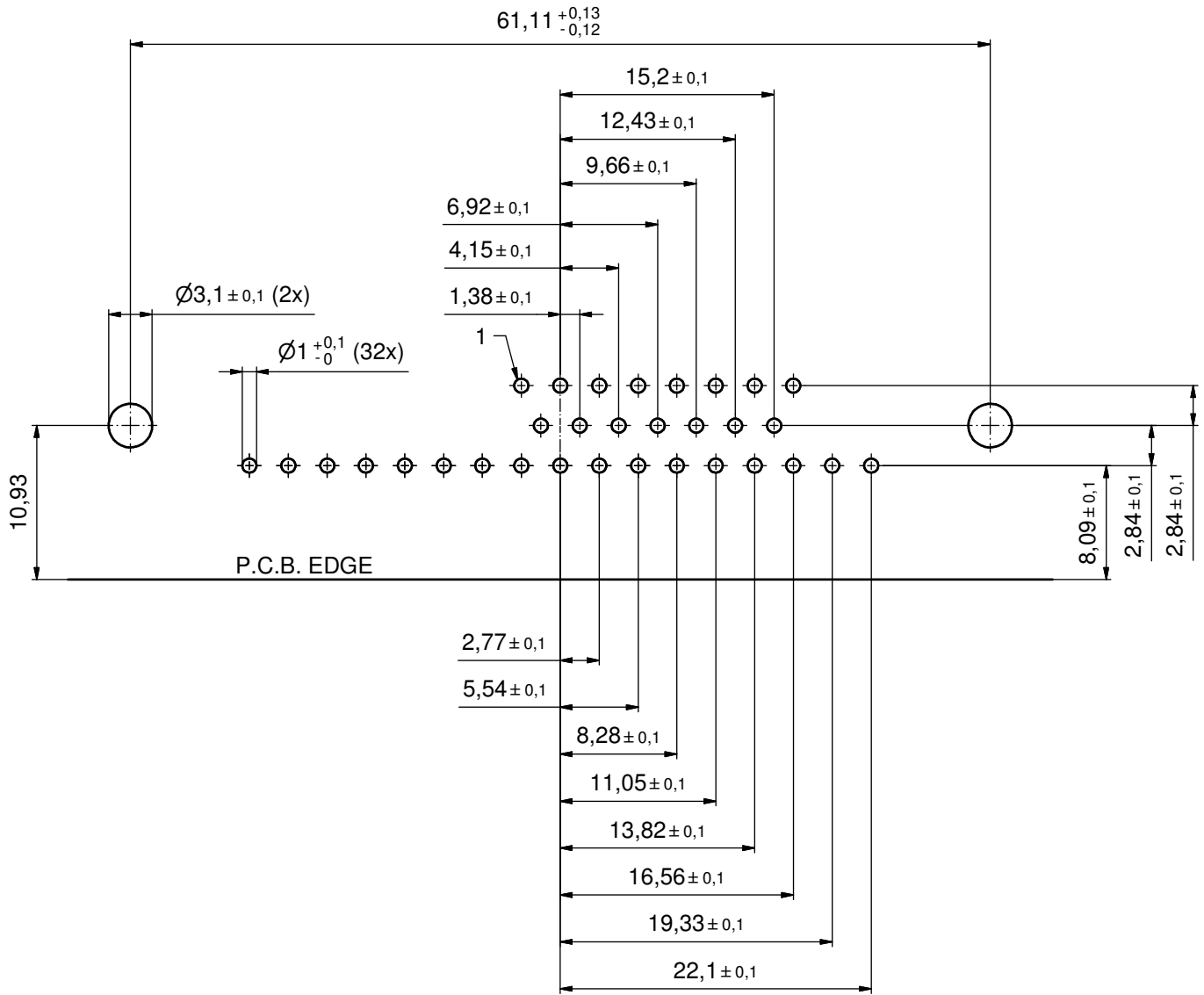

THIS DRAWING MAY NOT BE COPIED OR REPRODUCED IN ANY WAY, AND MAY NOT BE PASSED ON TO A THIRD PARTY WITHOUT WRITTEN PERMISSION. OWNERSHIP AND COPYRIGHT OF CONEC GmbH  DO NOT ALTER CAD DRAWING BY HAND					tolerance		scale: 3:1	
					date	name	material: SEE SHEET 1	
					drawn	30.01.15 Henneboel	title: <b>P.C.B. HOLE DRILLINGS</b> D-SUB COMBINATION MALE 90° 36W4P with threaded insert, metal bracket and snap	
					appd.	30.01.15 Lehmenkühler		
					norm			
					d-old			
	a	Original			<b>CONEC</b> <sup>®</sup>		dwg no: 13K1A4882	DIN-A3
	rev.	description	date	name			part no: SEE SHEET 1	sh: 2/2