

Part no. / Part marked/ Art.-Nr. / Bedruckung:	Quality class/ Gütestufe:	Contact plating/ Kontakt Veredelung:	Capacitance value/ Kapazitätswert:
24-009033	3	Gold flash over nickel <i>Gold über Nickel</i>	370 pF ± 20 %
24-009032	2	20 µm hard gold over min. 50 µm nickel <i>20 µm Gold über min. 50 µm Nickel</i>	
24-009031	1	30 µm hard gold over min. 50 µm nickel <i>30 µm Gold über min. 50 µm Nickel</i>	
24-009043	3	Gold flash over nickel <i>Gold über Nickel</i>	830 pF ± 20 %
24-009042	2	20 µm hard gold over min. 50 µm nickel <i>20 µm Gold über min. 50 µm Nickel</i>	
24-009041	1	30 µm hard gold over min. 50 µm nickel <i>30 µm Gold über min. 50 µm Nickel</i>	
24-009053	3	Gold flash over nickel <i>Gold über Nickel</i>	1300 pF ± 20 %
24-009052	2	20 µm hard gold over min. 50 µm nickel <i>20 µm Gold über min. 50 µm Nickel</i>	
24-009051	1	30 µm hard gold over min. 50 µm nickel <i>30 µm Gold über min. 50 µm Nickel</i>	

Technical specification/

Technische Daten:

Working voltage/ <i>Betriebsspannung:</i>	100 VDC
Current rating/ <i>Strombelastbarkeit:</i>	5 A
Insulation resistance/ <i>Isolationswiderstand:</i>	≥ 1 GΩ
Dielectric withstanding voltage/ <i>Spannungsfestigkeit (DWV):</i>	424 VDC
Temperature working range/ <i>Umgebungstemperatur:</i>	- 25 °C ... + 105 °C
Capacitance value/ <i>Kapazitätswert:</i>	see Table/ <i>siehe Tabelle</i>
Mating cycles/ <i>Steckzyklen:</i>	Quality class 1 = 500 <i>Gütestufe 1</i> Quality class 2 = 200 <i>Gütestufe 2</i> Quality class 3 = 50 <i>Gütestufe 3</i>

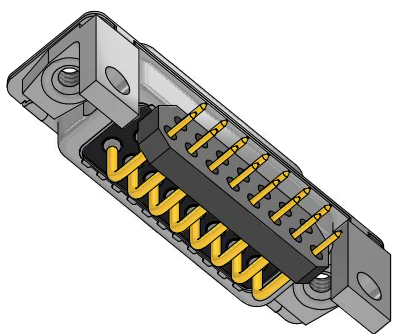

Materials/

Werkstoffe:

Contact/ <i>Kontakt:</i>	Cu alloy, Au over Ni Contact tails pretinned/ <i>Kontaktspitzen verzinkt</i>
Insulator/ <i>Isolierkörper:</i>	High temp. PA UL 94 V-0
Shell/ <i>Gehäuse:</i>	Steel, Sn over Ni
Metal bracket/ <i>Metallwinkel:</i>	GD-Zn, Sn over Ni
Threaded insert/ <i>Gewindeinsatz:</i>	Cu alloy, Sn over Ni
Ferrite/ <i>Ferrit:</i>	fixed with sealing compound/ mit Verguss geklebt

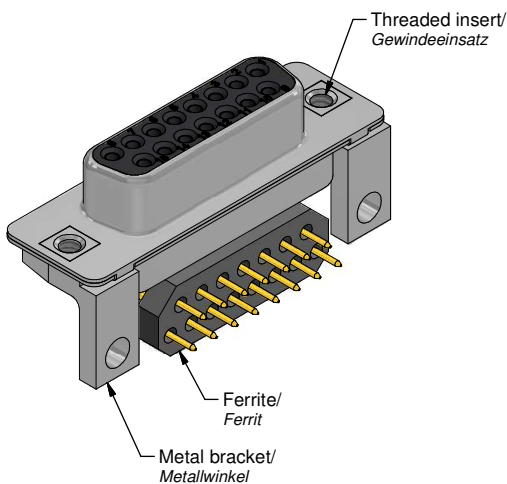

Installation specification/

Montagedaten:

Solder parameter/ <i>Lötparameter:</i>	
Solder preheat temperature/ <i>Vorheiztemperatur:</i>	100 °C for 30 sec./ <i>100 °C für 30 Sek.</i>
Solder bath temperature/ <i>Lötbadtemperatur:</i>	260 °C for 5 sec./ <i>260 °C für 5 Sek.</i>
PCB hole drillings/ <i>Leiterplattenbohrbild:</i>	see sheet 2/ <i>siehe Seite 2</i>
Recommended torque value for thread/ <i>Empfohlenes Drehmoment für Gewinde:</i>	max. 6 in.LB/ <i>max. 67 Ncm</i>

		dim. in mm		D-SUB LC-Filter female 15pos. solder pin angled 0.318 inch with metal bracket, threaded insert and ferrite	
		Date/Datum	Name	D-SUB LC-Filter Buchse 15pol. Lötstift abgewinkelt 7,19 mm mit Metallwinkel, Gewindeinsatz und Ferrit	
		drawn/gez.	24.10.2022	J.Brandt	
		appd./gepr.	24.10.2022	H.Schmidt	
Index: a Original	scale/Maßstab:	2:1		dwg no / Z.-nr.:	24K1A2422
RoHS compliant/konform				DIN-A3	1 / 2

PCB hole drillings
(PCB top side)
Leiterplattenbohrbild
(Leiterplatten Oberseite)

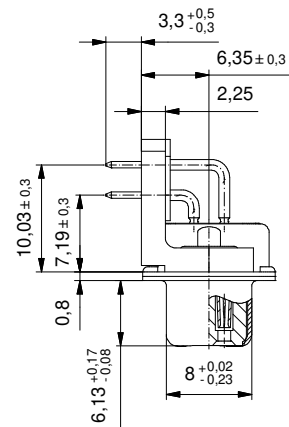
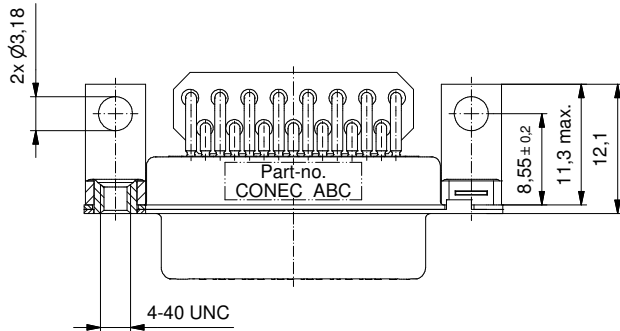
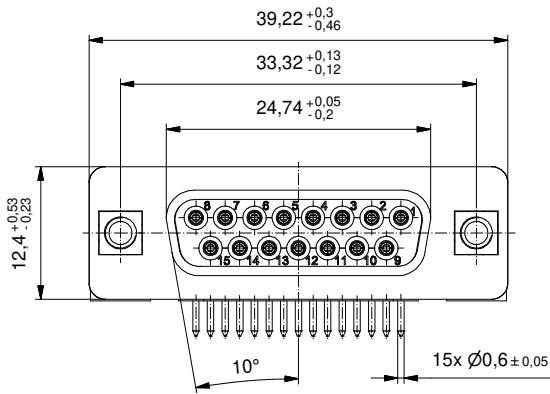
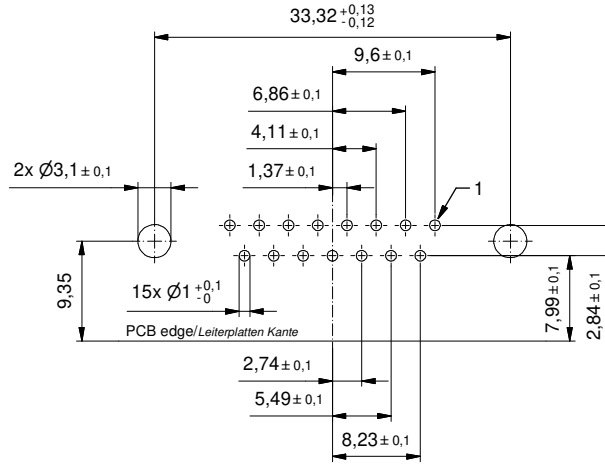

This reproduction, distribution and utilization of this document as well as the communication of its contents to others without express authorization is prohibited. Offenders will be held liable for the payment of damages. We reserve the right to withdraw advertising and notices, in whole or in part, without notice and without liability.

		dim. in mm		D-SUB LC-Filter female 15pos. solder pin angled 0.318 inch with metal bracket, threaded insert and ferrite D-SUB LC-Filter Buchse 15pol. Lötstift abgewinkelt 7,19 mm mit Metallwinkel, Gewindeeinsatz und Ferrit			
		Date/Datum	Name				
		drawn/gez.	24.10.2022			J.Brandt	
		appd./gepr.	24.10.2022	H.Schmidt			
Index: a Original	scale/Maßstab: 2:1			dwg no / Z.-nr.:	24K1A2422	DIN-A3	
RoHS compliant/konform						2 / 2	