

Part no. / Part marked/ Art.-Nr. / Bedruckung:	Quality class/ Gütestufe:	Contact plating/ Kontakt Veredelung:	Capacitance value/ Kapazitätswert:
24-008763	3	Gold flash over nickel <i>Gold über Nickel</i>	370 pF ± 20 %
24-008762	2	20 µin hard gold over min. 50 µin nickel <i>20 µin Gold über min. 50 µin Nickel</i>	
24-008761	1	30 µin hard gold over min. 50 µin nickel <i>30 µin Gold über min. 50 µin Nickel</i>	
24-008773	3	Gold flash over nickel <i>Gold über Nickel</i>	830 pF ± 20 %
24-008772	2	20 µin hard gold over min. 50 µin nickel <i>20 µin Gold über min. 50 µin Nickel</i>	
24-008771	1	30 µin hard gold over min. 50 µin nickel <i>30 µin Gold über min. 50 µin Nickel</i>	
24-008783	3	Gold flash over nickel <i>Gold über Nickel</i>	1300 pF ± 20 %
24-008782	2	20 µin hard gold over min. 50 µin nickel <i>20 µin Gold über min. 50 µin Nickel</i>	
24-008781	1	30 µin hard gold over min. 50 µin nickel <i>30 µin Gold über min. 50 µin Nickel</i>	

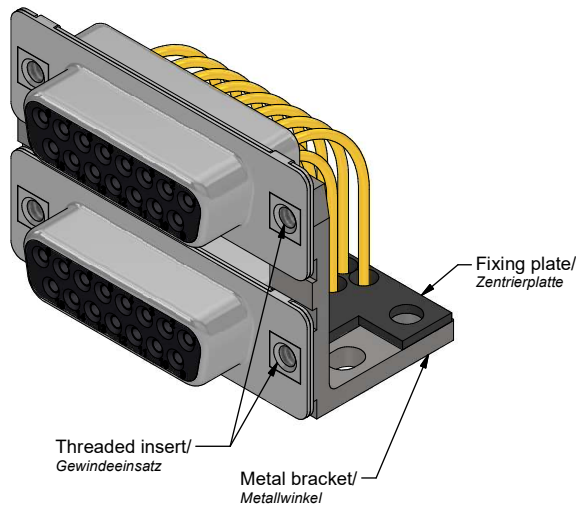
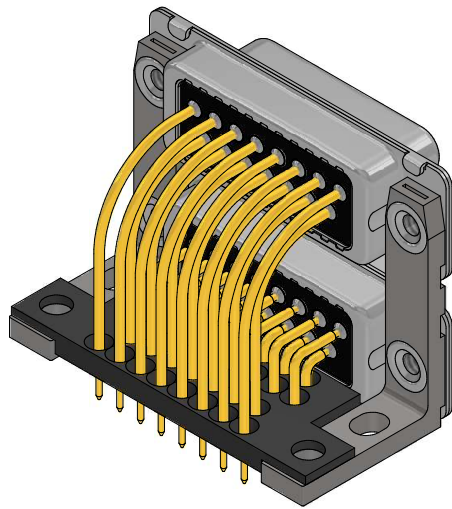

**Technical specification/
Technische Daten:**

Working voltage/ Betriebsspannung:	100 VDC
Current rating/ Strombelastbarkeit:	5 A
Insulation resistance/ Isolationswiderstand:	≥ 1 GΩ
Dielectric withstanding voltage/ Spannungsfestigkeit (DWV):	424 VDC
Temperature working range/ Umgebungstemperatur:	- 25 °C ... + 105 °C
Capacitance value/ Kapazitätswert:	see table/ siehe Tabelle
Mating cycles (see table)/ Steckzyklen (siehe Tabelle):	Quality class 1 = 500 Gütestufe 1 Quality class 2 = 200 Gütestufe 2 Quality class 3 = 50 Gütestufe 3

**Materials/
Werkstoffe:**

Contact/ Kontakt:	Cu alloy, Au over Ni Contact tails pretinned/ Kontaktspitzen verzinkt
Insulator/ Isolierkörper:	High temp. PA UL 94 V-0
Shells/ Gehäuse:	Steel, Sn over Ni
Metal bracket/ Metallwinkel:	GD-Zn, Sn over Ni
Threaded insert/ Gewindeeinsatz:	Cu alloy, Sn over Ni
Fixing plate/ Zentrierplatte:	High temp. PA UL 94 V-0

**Installation specification/
Montagedaten:**

Solder parameter/ Lötparameter:	
Solder preheat temperature/ Vorheiztemperatur:	100 °C for 30 sec./ 100 °C für 30 Sek.
Solder bath temperature/ Lötbadtemperatur:	260 °C for 5 sec./ 260 °C für 5 Sek.
PCB hole drillings/ Leiterplattenbohrbild:	see sheet 2/ siehe Seite 2
Recommended torque value for thread/ Empfohlenes Drehmoment für Gewinde:	max. 6 in.LB/ max. 67 Ncm

Index: a Original	Scale/ Maßstab: 2:1		dwg no / Z.-nr.: 24K1A2331	DIN- A3			
					dim. in mm	D-SUB Filter Dual Port 15,88 mm Female / Female 2 x 15pos. with metal bracket, threaded insert, fixing-plate	
					<table border="1"> <thead> <tr> <th>Date/Datum</th> <th>Name</th> </tr> </thead> <tbody> <tr> <td>08.09.2022</td> <td>J.Brandt</td> </tr> <tr> <td>08.09.2022</td> <td>H.Schmidt</td> </tr> </tbody> </table>	Date/Datum	Name
Date/Datum	Name						
08.09.2022	J.Brandt						
08.09.2022	H.Schmidt						
RoHS compliant/ konform				1 / 2			

The reproduction, distribution and sale of this document as well as the communication of its contents to others without express authorization is prohibited. Offenders will be held liable for the payment of damages. We reserve the right to withdraw advertising and/or to discontinue the publication of this document at any time without notice.

PCB hole drillings
(PCB top side)
Leiterplattenbohrbild
(Leiterplatten Oberseite)

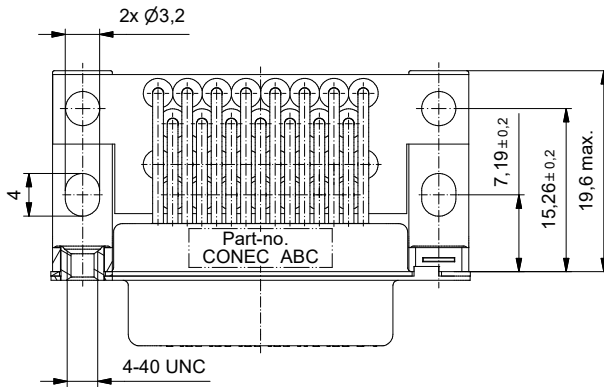
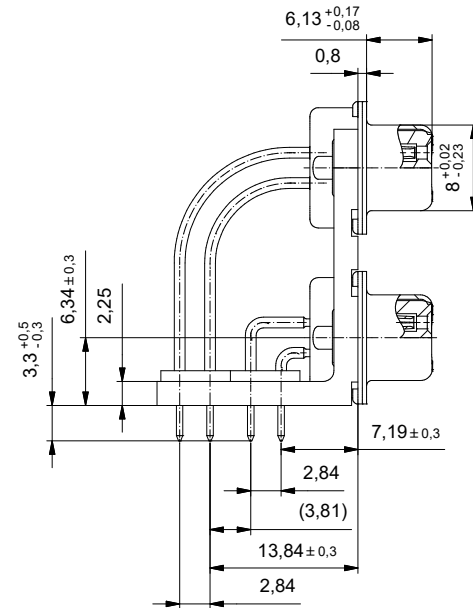
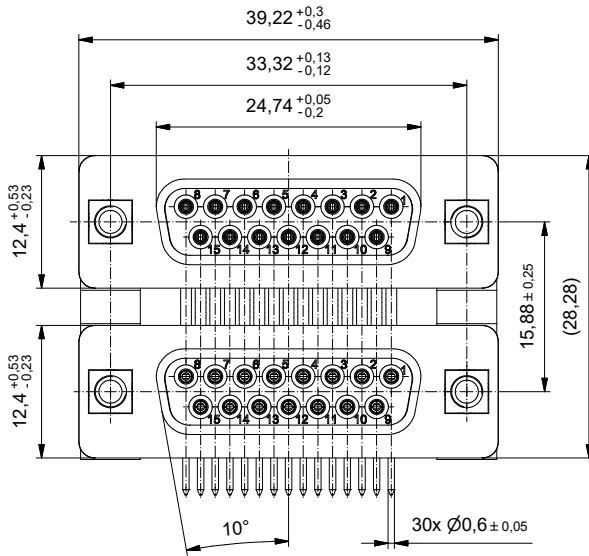
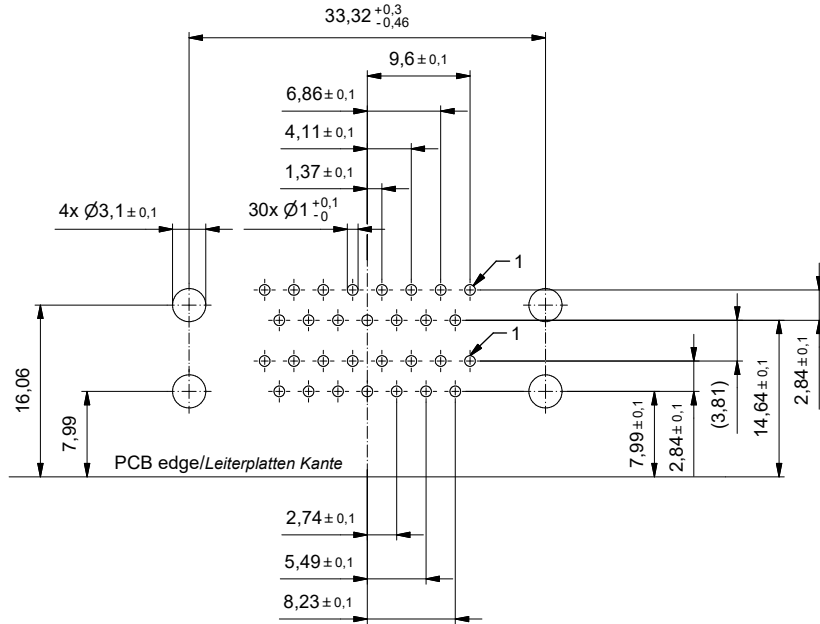

The reproduction, distribution and sale of this document as well as the communication of its contents to others without express authorization is prohibited. Offenders will be held liable for the payment of damages. We reserve the right to withdraw from circulation and/or to destroy copies of printed documents and/or electronic data files at any time without notice.

Index: a Original	Scale/Maßstab: 2:1		dim. in mm	D-SUB Filter Dual Port 15,88 mm Female / Female 2 x 15pos. with metal bracket, threaded insert, fixing-plate	DIN-A3					
			<table border="1"> <tr> <th>drawn/ges.</th> <th>Date/Datum</th> <th>Name</th> </tr> <tr> <td>08.09.2022</td> <td>08.09.2022</td> <td>J.Brandt</td> </tr> <tr> <th>appd./gepr.</th> <td>08.09.2022</td> <td>H.Schmidt</td> </tr> </table>	drawn/ges.		Date/Datum	Name	08.09.2022	08.09.2022	J.Brandt
drawn/ges.	Date/Datum	Name								
08.09.2022	08.09.2022	J.Brandt								
appd./gepr.	08.09.2022	H.Schmidt								
RoHS compliant/konform				dwg no / Z.-nr.: 24K1A2331	2 / 2					