

Cable clamp has to be ordered separately/  
*Kabelklemme muss separat bestellt werden*  
 09-37pos./ pol.  
 Part-no./ Art.-Nr.: 160X11189X  
 50pos./ pol.  
 Part-no./ Art.-Nr.: 160X11199X

**Materials/  
Werkstoffe:**

Hood/ Haube:	Die-cast Zinc/ Zinkdruckguss
Cover/ Deckel:	Die-cast Zinc/ Zinkdruckguss
Jack screw/ Rändelschraube:	Brass alloy, nickel plated/ Messinglegierung, vernickelt
Grounding screw/ Erdungsschraube:	Steel, zinc plated/ Stahl, verzinkt
Cover screw/ Deckelschraube:	Steel, nickel plated/ Stahl, vernickelt

**Installation specification/  
Montagedaten:**

Recommended torque value for jack screw/ Empfohlenes Drehmoment für Rändelschraube:	max. 0,5 - 0,6 Nm
Recommended torque value for grounding screw and cover screw/ Empfohlenes Drehmoment für Erdungsschraube und Deckelschraube:	max. 0,5 Nm

**Delivery includes/  
Lieferung umfasst:**

- 1x Hood with cover/  
Gehäuse mit Deckel
- Blanking plug/  
Blindstopfen
- 9pos./ 9pol:  
without blanking plug/  
ohne Blindstopfen
- 15pos./ 15pol:  
1x blanking plug/  
Blindstopfen
- 25-50pos./ 25-50pol:  
2x blanking plug/  
Blindstopfen
- 4x Cover screw/  
Befestigungsschraube
- 1x Earth screw/  
Erdungsschraube
- 2x Jack screw/  
Rändelschraube

Part no. bulk package/ Art.-Nr. Schüttgut	Part no. single package/ Art.-Nr. einzeln verpackt	No. of pos./ Polzahl
165X11609X	165X11609XE	09
165X11619X	165X11619XE	15
165X11629X	165X11629XE	25
165X11639X	165X11639XE	37
165X11649X	165X11649XE	50

general tolerance/ Allgemeintoleranz:	DIN ISO 2768-1 m	dim. in mm	Metal Hood 09-50pos. EMI/RFI shielding - with top and side cable exit Metallhaube 09-50pol. EMI/RFI Schirmung - mit geradem und seitlichem Kabelausgang	
			Date/Datum	Name
Index: c Ä25-1662 20.11.2025 ABU	scale/Maßstab: 1 : 1,5 (1 : 1)	drawn/ gez.	13.10.2021	Lehmenkühler
		appd./ gepr.	13.10.2021	Kölller
		dwg no / Z.-nr.:	16K1A4292	
			DIN-A3	
				1 / 2

The reproduction, distribution and utilization of this document as well as the communication of its contents to others without express authorization is prohibited. Offenders will be held liable for the payment of damages. All rights reserved in the event of the grant of a patent, utility model or design. Weirights: some Hervorhebung dieser Dokumente, Vervielfältigung dieser Dokumente sind verboten, soweit nicht ausdrücklich gestattet. Zuwiderhandlungen verpflichten zu Schadenersatz. © 2025 by Amphenol - CONEC.

9pos./ pol. ( 1 : 1,5 )

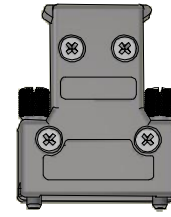
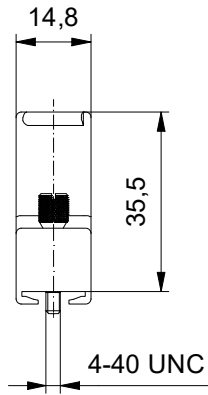
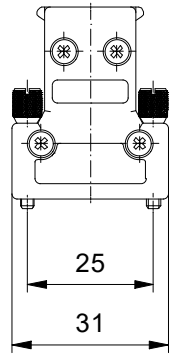

15pos./ pol. ( 1 : 1,5 )

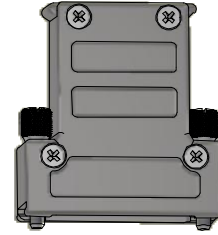
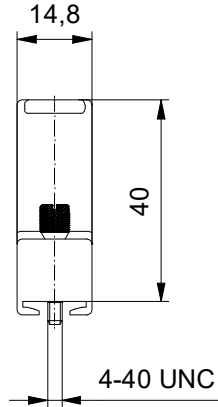
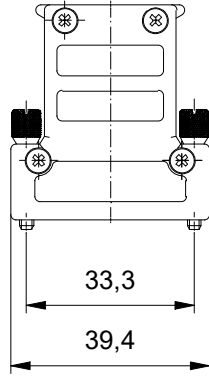

25pos./ pol. ( 1 : 1,5 )

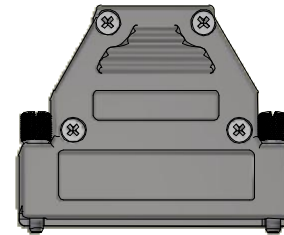
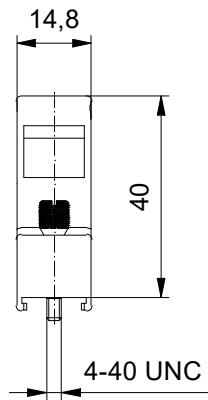
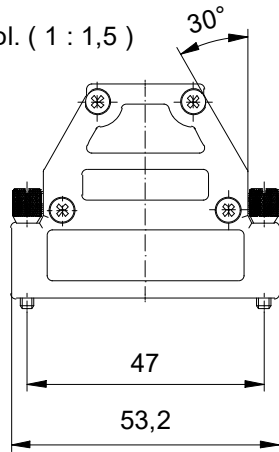

37pos./ pol. ( 1 : 1,5 )

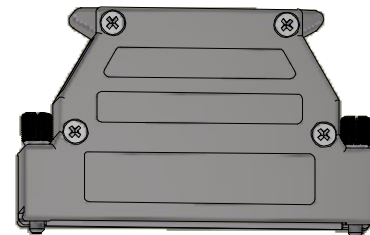
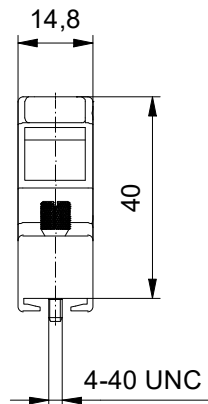
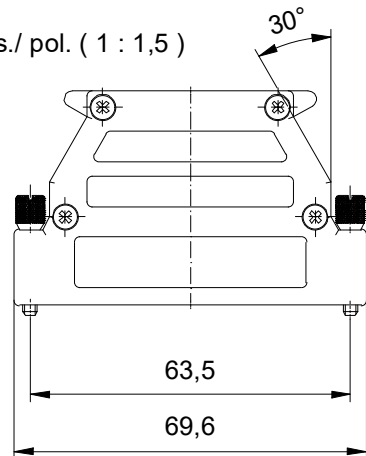

50pos./ pol. ( 1 : 1 )

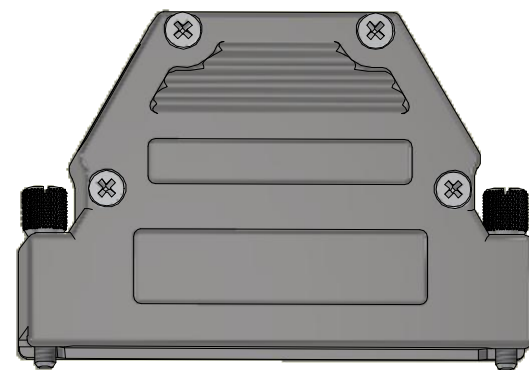
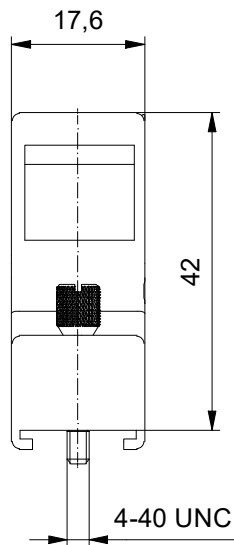
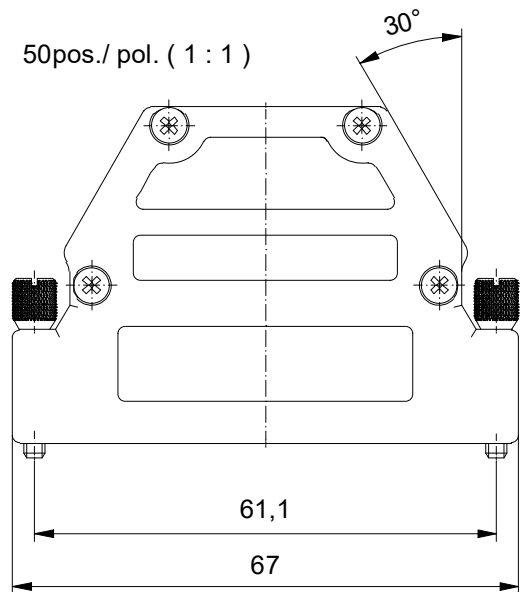

The reproduction, distribution and utilization of this document as well as the communication of its contents to others without express authorization is prohibited. Offenders will be held liable for the payment of damages. All rights reserved in the event of the grant of a patent, utility model or design. Weirights: some Hervorhebung dieses Dokuments, Vervielfältigung dieses Dokuments, Verbreitung und Mitteilung dieses Dokuments sind verboten, soweit nicht ausdrücklich gestattet. Zuwiderhandlungen verpflichten zu Schadenersatz. © 2021 by Amphenol Conect, Germany.

general tolerance/ Allgemeintoleranz: DIN ISO 2768-1 m		dim. in mm		Metal Hood 09-50pos. EMI/RFI shielding - with top and side cable exit Metallhaube 09-50pol. EMI/RFI Schirmung - mit geradem und seitlichem Kabelausgang	
		drawn/ gez. 13.10.2021	Name Lehmenkühler		
Index: c Ä25-1662 20.11.2025 ABU		appd./ gepr. 13.10.2021	Köller	dwg no / Z.-nr.: 16K1A4292	
		scale/Maßstab: 1 : 1,5 (1 : 1)			
Amphenol CONEC®			2 / 2		